



October 30, 2018

Village of Hinsdale
19 E Chicago Ave
Hinsdale, IL 60521

Subject: Permit application to perform ComEd cable replacement work in existing easements and/or ROW in the Village of Hinsdale-Ref 3973.

On behalf of ComEd, INTREN LLC. will be replacing, installing new and abandoning old, Underground Residential Distribution (URD) Cables in several locations within your village (see attached map). Construction is tentatively scheduled to start 12/05/2018 and complete on or about 12/06/2018, approximately 2 working days.

We will be using directional boring method for the installation of cable with final landscaping (topsoil, seed, and blanket) to follow within 3 weeks of completion of work.

Please let me know if there is anything else you need from us in order to proceed with the work.

Thank you,

A handwritten signature in black ink that reads "Diane Loftin" followed by the initials "DLB".

Diane Loftin
Assistant Project Manager
INTREN, LLC.
815-923-2300 x226
dloftin@intren.com

ComEd Contact:
William Nolan
Principal Project Manager
630-437-2505

Attachments: Permit Application/Notification/ComEd Maps

PERMIT APPLICATION / NOTIFICATION TO PERFORM WORK REF 3973

() COUNTY: DuPage WORK TASK# 15456817

() COUNTY ROUTE: _____ P.L. # 465132

() TOWNSHIP: _____ TOWNSHIP CODE: 465

(X) MUNICIPALITY: Hinsdale SECTION: 13

TO: Village of Hinsdale INTREN ENG: Diane Loftin
19 E Chicago Ave
Hinsdale, IL 60521 PHONE # 815-923-2300 x226

TENTATIVE START: 12/05/2018

TENTATIVE COMPLETION: 12/06/2018

Replace approx. 1150 feet of underground cable using the directional bore method in existing easement/ROW and abandon old cable.

Note: See area maps for cable replacement location.

REASON FOR WORK: Reliability improvements

SIGNED: Diane Loftin DATE: 10/30/2018

E-MAIL ADDRESS dloftin@intren.com

PERMIT GRANTED

SIGNED: _____ DATE: _____

PERMIT NUMBER: _____

Village of Hinsdale 2018 Cable Replacement Project

REF 3973



Geographical Work Area

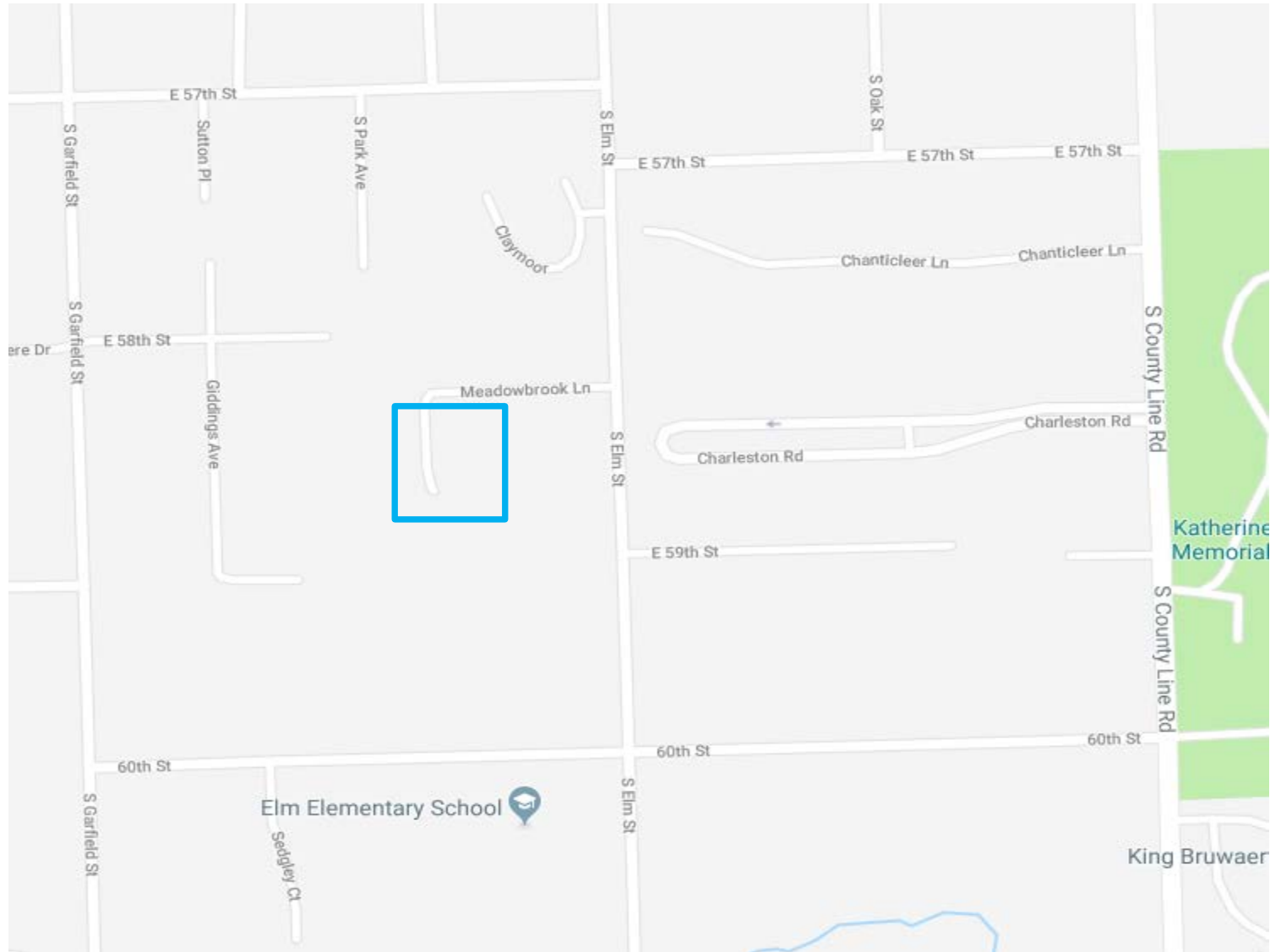

Village of Hinsdale 2018 Cable Replacement Project

REF 3973



Legend

- Proposed cable replacement
- Existing transformers
- Existing pole

Note: All Proposed cable paths in dedicated utility easements and/or ROW

Note: The utilities shown here is the best representation based on record drawings. Actual field conditions may differ from what is shown

REF

3973

W.O.

15456817

132A

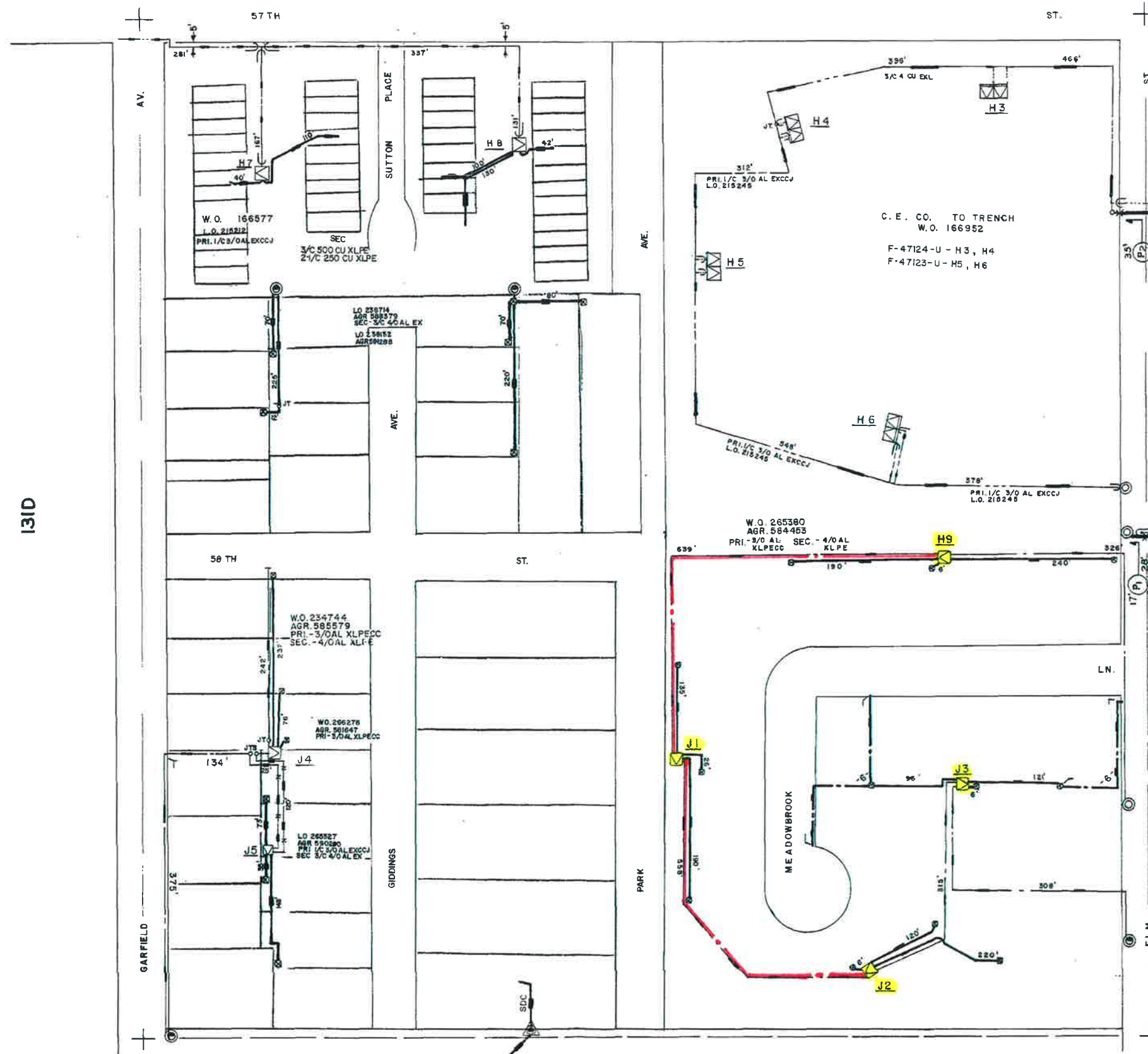

- LEGEND**
- Existing Pole
 - Existing Transformer
 - Proposed Cable Replacement
 - Existing Primary Cable

CABLE NOTES

P₁ 3/C 750 STRD AL EXCCJ
 P₂ 3/C 4 STRD CU EXLJ

Note: All proposed cable paths in dedicated utility easements and/or ROW

Note: All utilities shown here are the best representation based on record drawings. Actual field conditions may differ from what is shown.

UNDERGROUND	
DRAWN 3-4-67	SCALE 1" = 100'
REVISED	10-21-96
DOWNERS GROVE TWP.	
DUPAGE	CO.
465132C	

131D

132D

134A