



5N301 Medinah Rd
Addison IL 60101

REQUEST FOR PERMIT

To: Village of Hinsdale
Dan Deeter, Village Engineer
19 E Chicago Av
Hinsdale, IL 60521

Comcast Application No.: TAC-768388RP
Village No.: _____
Expires On: _____

Dear Mr. Deeter,

Application is hereby submitted by Comcast & Talon Communications for permission to perform the work as specified below:

To install replacement CATV cable at a depth of 36" min along the directional bore line as shown on the attached drawing.

REASON FOR WORK:

To install replacement CATV cable between two (2) existing utility poles across Chicago Avenue as shown on the drawing. All CATV cable will be installed underground by directional boring in the same location as existing damaged cable. Permit to include a road bore to go underneath Chicago Avenue.

SEE ATTACHED DRAWING FOR MORE INFORMATION.

Note: All restoration will conform to the specifications required by the Village of Hinsdale, IL
Restoration to be completed within 14 working days of installation.

Permit Requested By: Adriana Candia, COMCAST Construction Specialist Date: 8/27/18

Permit Granted By: _____ Date: _____

Contact:	Phone:	email:
Adriana Candia, COMCAST Const. Specialist 5N301 Medinah Rd, Addison, IL 60101	224.229.6594	adriana_candia@comcast.com
Bill Zebrauskas, Talon Communications 305 Amston Ct, Oswego, IL 60543	708.537.3145	billzebrauskas@gmail.com
Olivia Carlin, ESPO Engineering 845 Midway Drive, Willowbrook, IL 60527-5549	630.522.3024	ocarlin@espocorp.com

VILLAGE OF HINSDALE PERMIT DRAWINGS 23 S GARFIELD ST

FINDER SKETCH

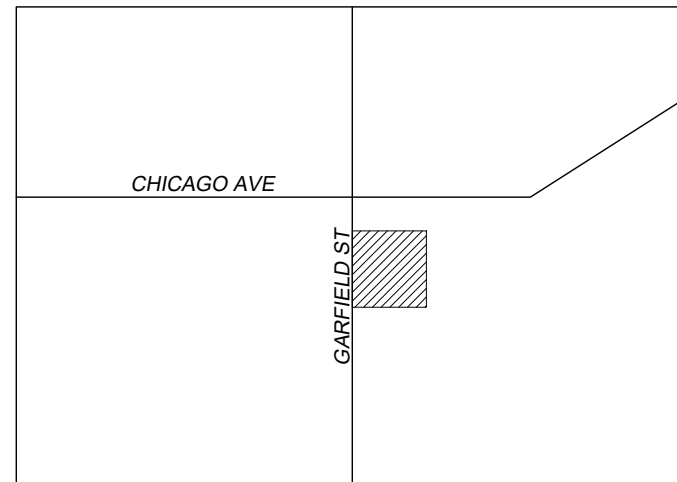

NOT TO SCALE

DuPAGE COUNTY
DOWNERS GROVE TWP T38N R11E
N.W.1/4 OF N.E.1/4 OF SEC.12

LEGEND

SYMBOLS

⊗ JOINT POLE	Ⓜ MAIL BOX
× POWER POLE	▬ FIBER MARKER
⊠ TRANSFORMER POLE	⊕ GAS MARKER (Indicate Ownership)
○ TELEPHONE POLE	⊖ GAS METER
● CATV POLE	⊗ RIGHT-OF-WAY MARKER (Bench Mark)
□ CATV PED	⊗ RAILROAD CROSSING GATE
▣ CATV LOCKBOX	Ⓜ ROAD SIGN
Ⓜ CATV VAULT	☀ STREET LIGHT
Ⓜ TELCO VAULT	☀ TRAFFIC SIGNAL LIGHT
Ⓜ TELCO PED	Ⓜ GUY AND ANCHOR
Ⓜ TRANSFORMER	Ⓜ FIRE HYDRANT
Ⓜ CATV POWER SUPPLY	Ⓜ CATCH BASIN
Ⓜ AIR CONDITIONER	Ⓜ SEWER DRAIN
Ⓜ ELECTRIC VAULT/PED/METER	Ⓜ WATER VALVE
Ⓜ TRAFFIC CONTROL VAULT	Ⓜ GAS VALVE
Ⓜ UNMARKED VAULT	Ⓜ CULVERT PIPE
Ⓜ CATV MANHOLE	Ⓜ TREE
Ⓜ SEWER MANHOLE (Indicate Sanitary/Storm)	Ⓜ BUSH
Ⓜ WATER MANHOLE (Indicate Ownership i.e. DWC)	Ⓜ HEDGES
Ⓜ UNMARKED MANHOLES	Ⓜ BORE/SPLICE PIT

LINES

— — — — —	CENTER LINE
- - - - -	RIGHT-OF-WAY LINE
— — — — —	PROPERTY LINE
— · — · — · — · — · — · — · — ·	UTILITY EASEMENT
— — — — —	CURB LINE
— — — — —	OVERHEAD CABLE
— · — · — · — · — · — · — · — ·	UNDERGROUND CABLE
— W — W — W — W — W —	WATER MAIN
— S — S — S — S — S —	SANITARY SEWER
— G — G — G — G — G —	STORM SEWER MAIN
— G — G — G — G — G —	GAS MAIN
— TEL — TEL — TEL — TEL —	TELCO CABLE
— E — E — E — E — E —	BURIED ELECTRIC CABLE
— — — — —	FENCE



THE INFORMATION IN THIS DRAWING FILE IS PROPRIETARY AND CONFIDENTIAL AND MAY NOT BE REPRODUCED OR TRANSMITTED BY ANY MEANS OF CONVEYANCE WITHOUT WRITTEN PERMISSION FROM COMCAST.

TALON COMMUNICATIONS

305 AMSTON CT, OSWEGO IL 60543 ; (630) 926-4951

JOB NO.: TAC-768388RP

PROJECT TITLE: COMCAST U-GROUND
COMMUNICATION CABLE
REPLACEMENT

LOCATION: 23 S GARFIELD ST
HINSDALE, IL

DRAWING NO. TAC-768388RP

NODE NO. N/A

CABLE TYPE: COAX

SHEET NO. 1 OF 2

ESPO ENGINEERING

845 MIDWAY DR WILL OXBROOK, IL 60527
630.789.2525
www.espcorp.com

DRAWN BY: GTP DATE: 8/22/18

APPROVED: - DATE: -

ENG NUMBER: TAC-0818-B853

ISSUED FOR PERMITTING

SCALE: 1"=50'

REVISIONS

DATE	BY	DESCRIPTION
-	-	-
-	-	-
-	-	-



LEGEND

SYMBOLS	
⊗ JOINT POLE	✕ POWER POLE
⊙ TRANSFORMER POLE	⊖ TELEPHONE POLE
● CATV POLE	□ CATV PED
▣ CATV LOCKBOX	Ⓜ CATV VAULT
Ⓜ TELCO VAULT	Ⓜ TELCO PED
Ⓜ TRANSFORMER	Ⓜ CATV POWER SUPPLY
Ⓜ AIR CONDITIONER	Ⓜ ELECTRIC VAULT/PED/METER
Ⓜ TRAFFIC CONTROL VAULT	Ⓜ UNMARKED VAULT
Ⓜ CATV MANHOLE	Ⓜ SEWER MANHOLE (Indicate Sanitary/Storm)
Ⓜ WATER MANHOLE (Indicate Ownership i.e. DMC)	Ⓜ UNMARKED MANHOLES
Ⓜ MAIL BOX	Ⓜ FIBER MARKER
Ⓜ GAS MARKER (Indicate Ownership)	Ⓜ GAS METER
Ⓜ RIGHT-OF-WAY MARKER (Bench Mark)	Ⓜ RAILROAD CROSSING GATE
Ⓜ ROAD SIGN	Ⓜ STREET LIGHT
Ⓜ TRAFFIC SIGNAL LIGHT	Ⓜ GUY AND ANCHOR
Ⓜ FIRE HYDRANT	Ⓜ CATCH BASIN
Ⓜ SEWER DRAIN	Ⓜ WATER VALVE
Ⓜ GAS VALVE	Ⓜ CULVERT PIPE
Ⓜ TREE	Ⓜ BUSH
Ⓜ HEDGES	Ⓜ BORE/SPLICE PIT

LINES	
— — — — —	CENTER LINE
- - - - -	RIGHT-OF-WAY LINE
⋯ ⋯ ⋯	PROPERTY LINE
⋯ ⋯ ⋯	UTILITY EASEMENT
— — — — —	CURB LINE
— — — — —	OVERHEAD CABLE
— — — — —	UNDERGROUND CABLE
— W — W — W — W — W —	WATER MAIN
— S — S — S — S — S —	SANITARY SEWER
— G — G — G — G — G —	STORM SEWER MAIN
— G — G — G — G — G —	GAS MAIN
— TEL — TEL — TEL — TEL —	TELCO CABLE
— E — E — E — E — E —	BURIED ELECTRIC CABLE
— — — — —	FENCE



THE INFORMATION IN THIS DRAWING FILE IS PROPRIETARY AND CONFIDENTIAL AND MAY NOT BE REPRODUCED OR TRANSMITTED BY ANY MEANS OF CONVEYANCE WITHOUT WRITTEN PERMISSION FROM COMCAST.

TALON COMMUNICATIONS

305 AMSTON CT, OSWEGO IL 60543 ; (630) 926-4951

JOB NO.: TAC-768388RP

PROJECT TITLE: COMCAST U-GROUND COMMUNICATION CABLE REPLACEMENT

LOCATION: 23 S GARFIELD ST HINSDALE, IL

DRAWING NO. TAC-768388RP

NODE NO. N/A

CABLE TYPE: COAX

SHEET NO. 2 OF 2

ESPO ENGINEERING

845 MIDWAY DR WILLOWBROOK, IL 60527
630.789.2525
www.espocorp.com

DRAWN BY: GTP DATE: 8/22/18

APPROVED: - DATE: -

ENG NUMBER: TAC-0818-B853

ISSUED FOR PERMITTING

SCALE: 1"=50'

REVISIONS		
DATE	BY	DESCRIPTION
-	-	-
-	-	-
-	-	-

